



Installation Recommendations for New Construction Casement, Awning, Hung, Picture Window Flange and Finless

the integration of finless products into a typical wood-framed window less than three stories in height. Installation into other structures and frame types are not addressed here.

Please contact MI or visit www.miwindows.com for additional information.

Important Design Considerations

Read this entire document before proceeding with installation of MI's products. Responsibility for product selection and installation rests with the owner, architect, and installer. Do not proceed with installation unless all factors necessary to properly integrate MI's products into a building's water management system have been addressed.

MI makes no representation or warranty that these recommendations include all information necessary to ensure proper integration into every building. State and local code requirements may impose different or additional demands which will supersede these recommendations. For additional guidance regarding installation of window products, refer to applicable industry standards (e.g., AAMA 2400, AAMA InstallationMasters™, ASTM E 2112).

Failure to follow these recommendations, local requirements, or good building practices may affect the availability of remedies under MI's warranty. Provide a copy of these recommendations and the applicable MI warranty to the owner before installing. MI does not permit adoption of its installation recommendations into the contracts of others without its prior, written consent.

Important Pre-Installation Considerations

- Window installation may disturb finish surfaces and paint in existing structures. Specific notice and work site precautions may be required. Additional information is available at www.epa.gov/lead. Comply with all applicable federal, state, and local requirements.
- Job site and worker protections are recommended and may be required. Follow all manufacturers' instructions for appropriate and safe use of protective equipment, tools, materials, hardware and site protections necessary for installation.
- Special disposal considerations may be necessary for materials used during installation. Materials removed from an existing structure may also have their own disposal or recycling requirements. Comply with all applicable federal, state, and local requirements.
- Product specification sheets include important information regarding your product and may include additional installation recommendations, such as fastener use with impact resistant windows, finishing instructions, and appropriate use of low expansive foam insulation.

Contact MI for product specifications and additional product information for your MI product.

Materials Required

- Non-compressible shims.
-

Tools Required

Inspect and Prepare the Product for Installation

1. Inspect the window product thoroughly before beginning installation.

- Confirm the window matches the size needed for the opening; measuring $\frac{1}{2}$ " smaller than the rough opening dimensions in width and height.
-

7. For flange and finless window units, place the installation screws in the predrilled holes in the new window frame.

New window unit being installed over old window unit. The old window unit is being removed and the new window unit is being installed in its place.

8. Adjustments may have to be made several times until satisfactory performance is achieved. Adjustments can also be made by loosening and tightening the previously installed jamb screws.

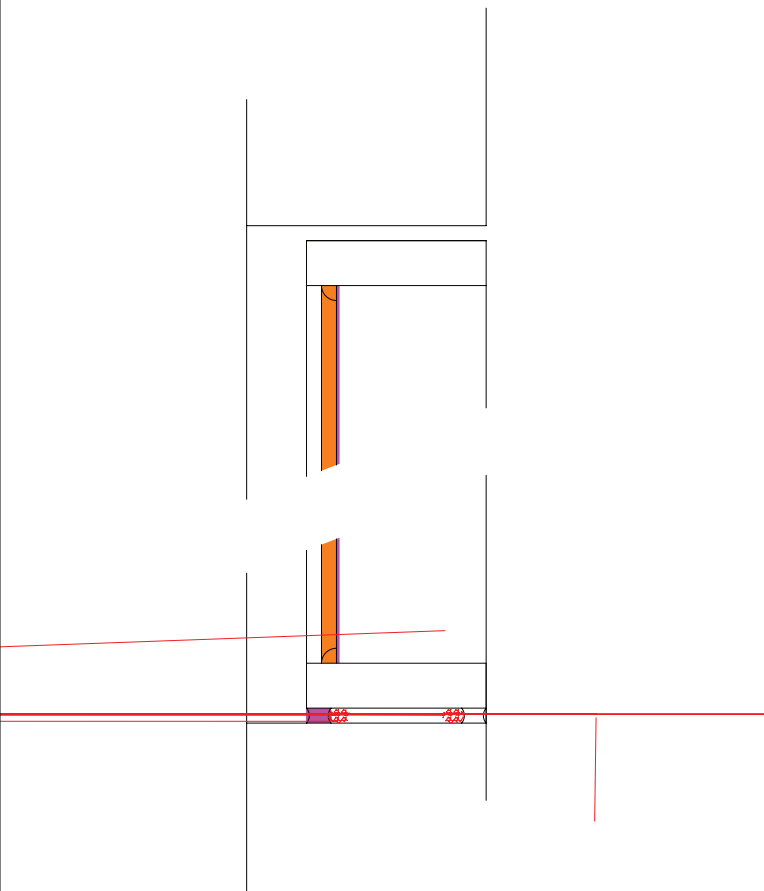

Considerations and Cautions

Important Cautions

- ⚠ Use of solvents or acids will damage components of this product and will limit rights under the warranty.
- ⚠ Vinyl windows have pre-punched slots for installation—fastening in any other portion may permanently damage unit which will limit rights under the warranty.
- ⚠ It is the sole responsibility of the owner, architect, and/or builder to select correct products to be in compliance with applicable laws, site requirements, and building codes and to ensure that installation is in compliance with applicable laws, site requirements and building codes.
- ⚠ Do not store in the sun or lay flat before or during installation.
- ⚠ Any penetrations (e.g. alarm sensors) made through any portion of any MI Windows and Doors, Inc. product may affect rights under the manufacturer's warranty.
- ⚠ Some laws and building codes require safety glass. The ordering party is responsible to specify safety glass and ensure compliance.

Post-Installation Reminders

- With the exception of logo and NFRC labels, all MI applied labels should remain in place and not be removed after installation is complete (e.g., AAMA labels, warranty labels, warning labels).
- MI recommends a yearly inspection of its products and the surrounding materials, inside and outside the home. Upkeep of sealant joints, hardware and weather stripping can ensure longevity and proper functioning of the window products.

Please contact MI or visit www.miwindows.com for additional information. **MI INTERIOREXTERIOR**